

SETTING UP WIFI

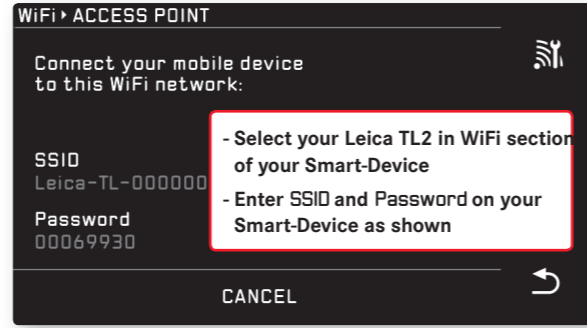

93570 VII/18/B

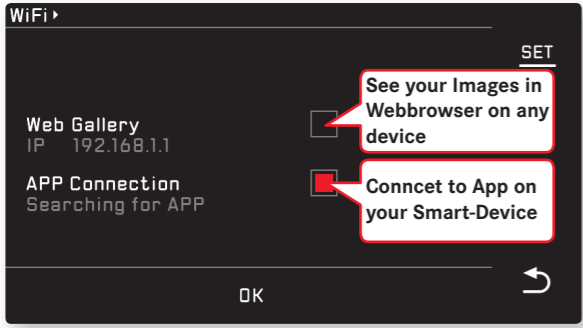
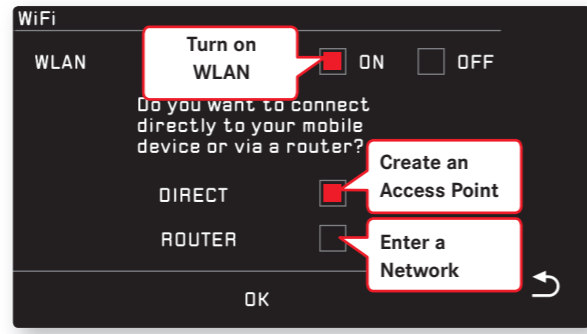
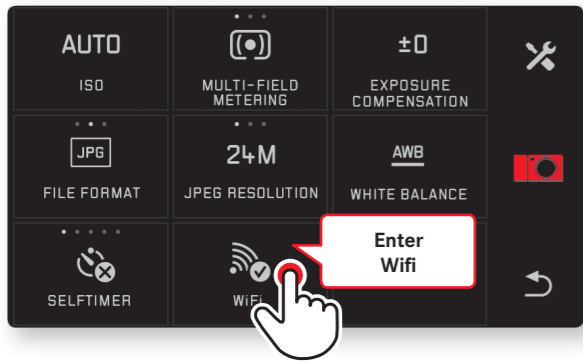

LEICA TL2 QUICK-START-GUIDE

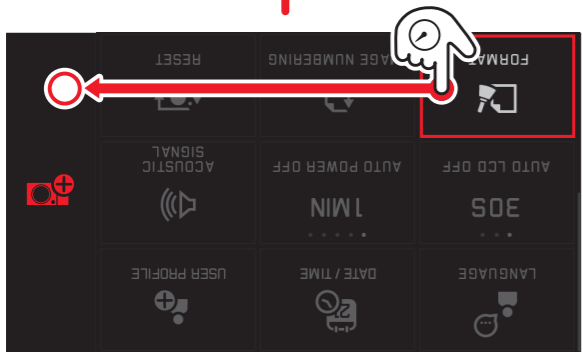
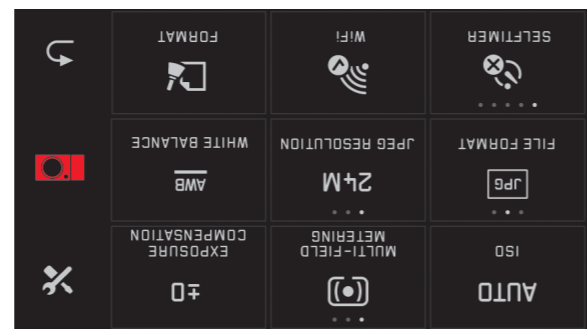
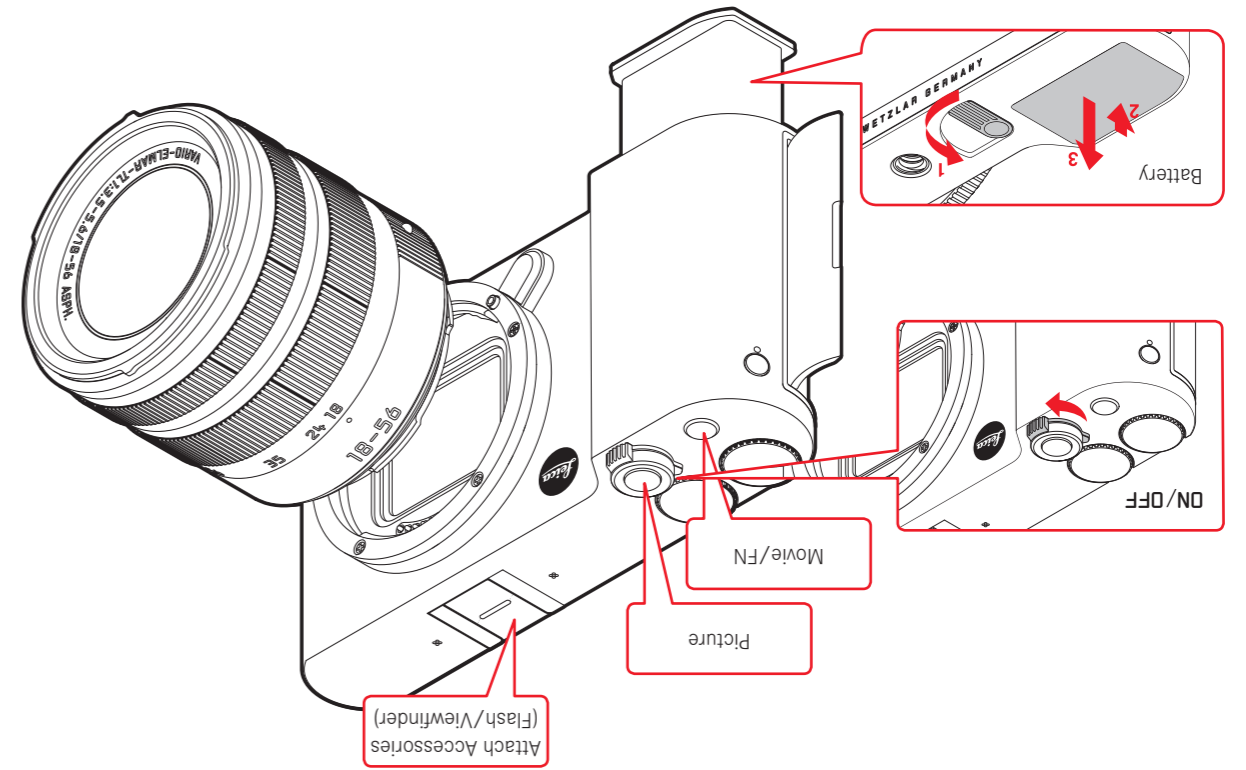
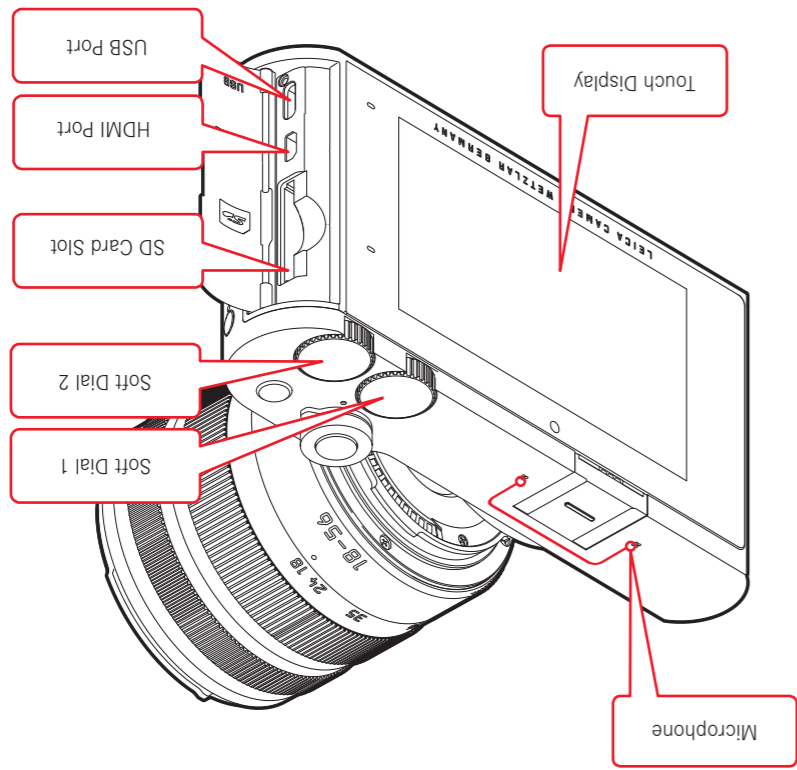

PERSONALIZE MY CAMERA MENU

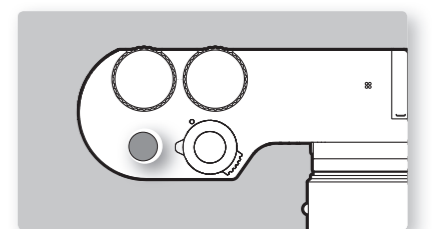
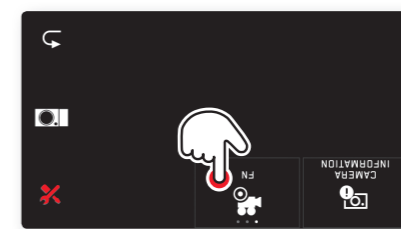
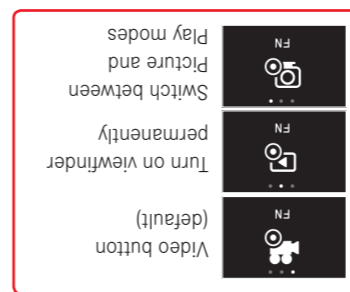

PERSONALIZE FUNCTION BUTTON

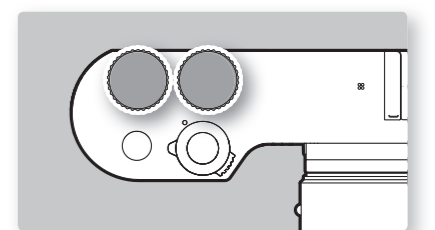
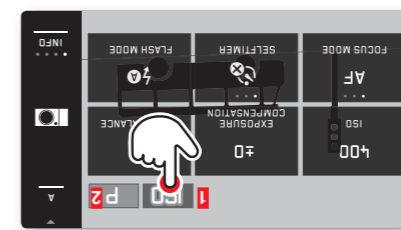
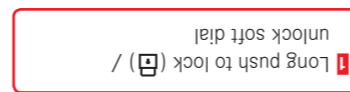

PERSONALIZE SOFT DIALS

SWITCHING BETWEEN PICTURE AND PLAY MODES

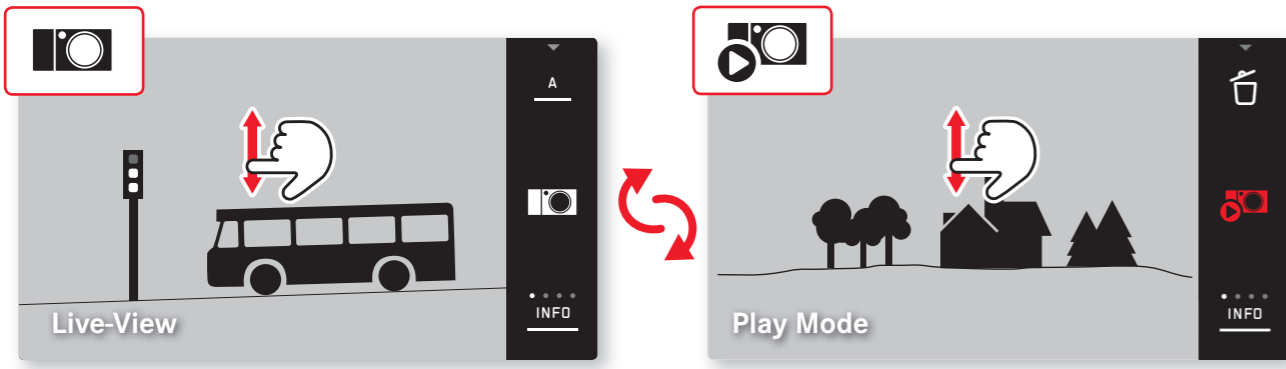

PLAY MODE FUNCTIONS

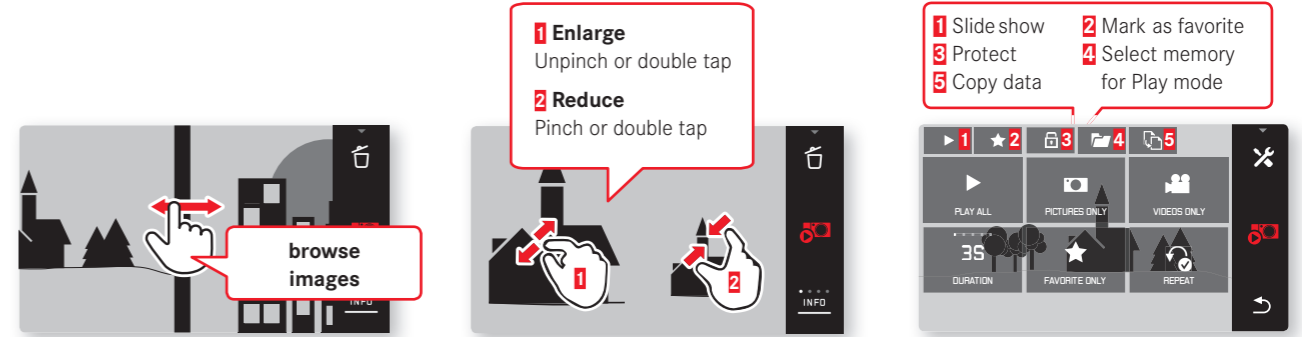

SWITCHING BETWEEN PICTURE AND VIDEO PREVIEW MODES

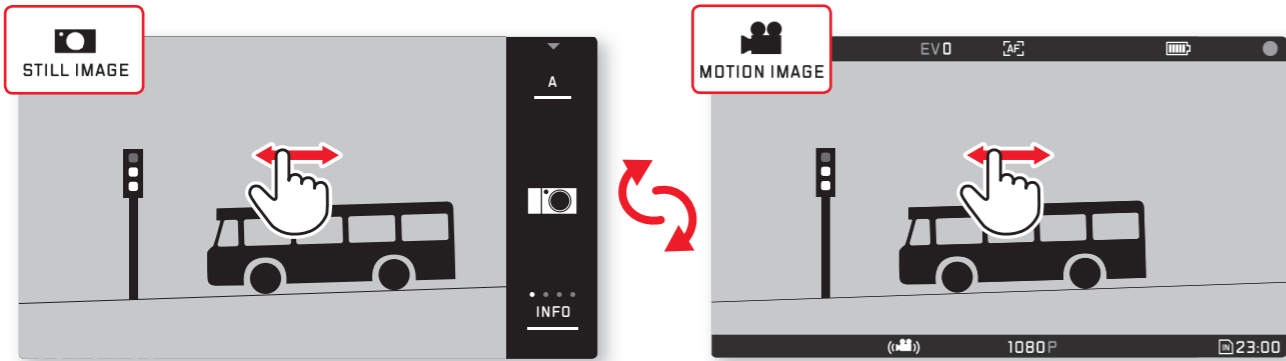

MENU FUNCTIONS

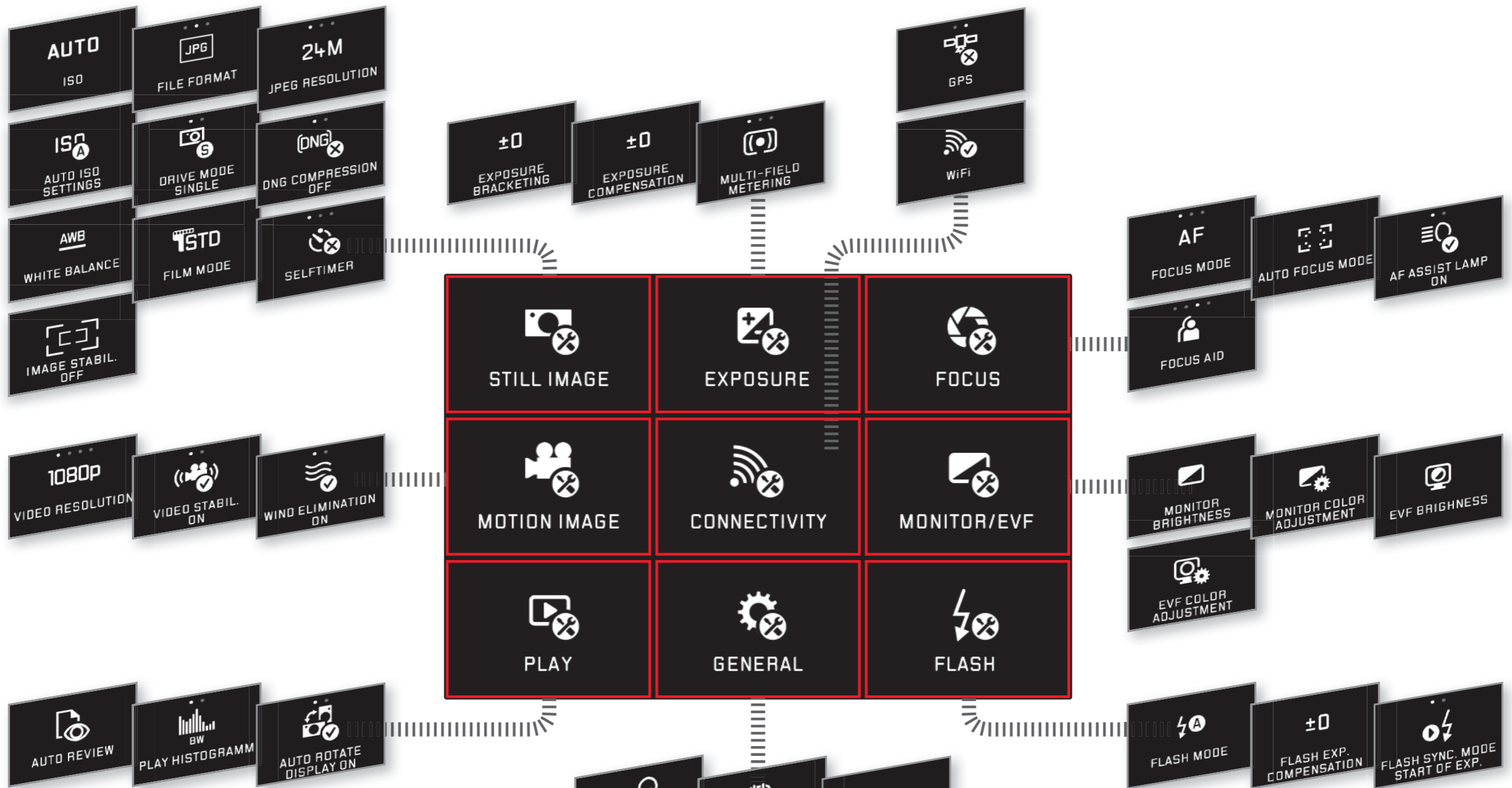
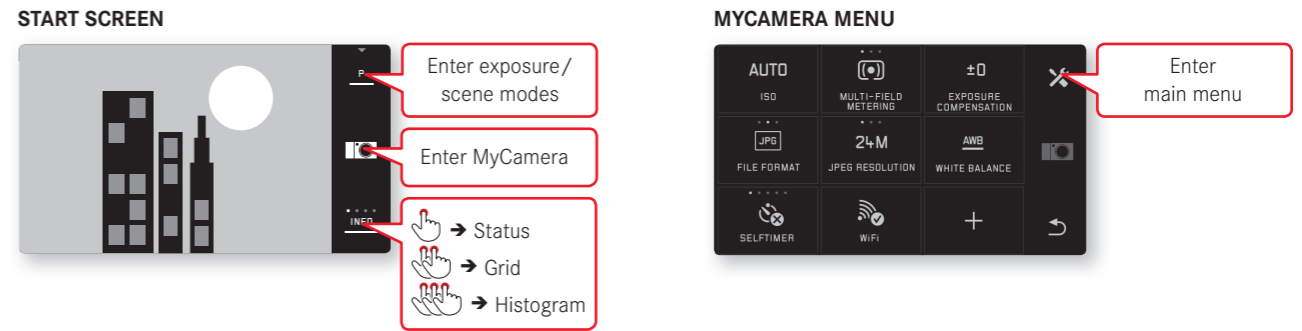

NAVIGATING IN MENUS

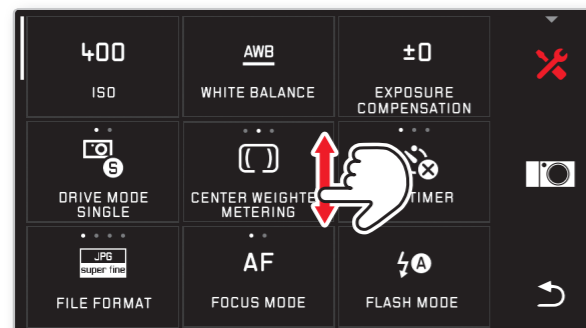

TOUCH TO ENTER A MENU ITEM'S SUBMENU/CHANGE SETTINGS

